



EN

Retrofit option

ON 8pol

099-002465-EW501

Observe additional system documents!

26.04.2019

**Register now
and benefit!
Jetzt Registrieren
und Profitieren!**

www.ewm-group.com



General instructions

WARNING



Read the operating instructions!

The operating instructions provide an introduction to the safe use of the products.

- Read and observe the operating instructions for all system components, especially the safety instructions and warning notices!
- Observe the accident prevention regulations and any regional regulations!
- The operating instructions must be kept at the location where the machine is operated.
- Safety and warning labels on the machine indicate any possible risks. Keep these labels clean and legible at all times.
- The machine has been constructed to state-of-the-art standards in line with any applicable regulations and industrial standards. Only trained personnel may operate, service and repair the machine.
- Technical changes due to further development in machine technology may lead to a differing welding behaviour.

In the event of queries on installation, commissioning, operation or special conditions at the installation site, or on usage, please contact your sales partner or our customer service department on +49 2680 181-0.

A list of authorised sales partners can be found at www.ewm-group.com/en/specialist-dealers.

Liability relating to the operation of this equipment is restricted solely to the function of the equipment. No other form of liability, regardless of type, shall be accepted. This exclusion of liability shall be deemed accepted by the user on commissioning the equipment.

The manufacturer is unable to monitor whether or not these instructions or the conditions and methods are observed during installation, operation, usage and maintenance of the equipment.

An incorrectly performed installation can result in material damage and injure persons as a result. For this reason, we do not accept any responsibility or liability for losses, damages or costs arising from incorrect installation, improper operation or incorrect usage and maintenance or any actions connected to this in any way.

© EWM AG

Dr. Günter-Henle-Strasse 8
56271 Mündersbach Germany
Tel.: +49 2680 181-0, Fax: -244
Email: info@ewm-group.com

www.ewm-group.com

The copyright to this document remains the property of the manufacturer.

Copying, including extracts, only permitted with written approval.

The content of this document has been prepared and reviewed with all reasonable care. The information provided is subject to change; errors excepted.

1 For your safety

1.1 Safety instructions

WARNING



Do not carry out any unauthorised repairs or modifications!

To avoid injury and equipment damage, the unit must only be repaired or modified by specialist, skilled persons!

The warranty becomes null and void in the event of unauthorised interference.

- Appoint only skilled persons for repair work (trained service personnel)!



Risk of accidents due to non-compliance with the safety instructions!

Non-compliance with the safety instructions can be fatal!

- Carefully read the safety instructions in this manual!
- Observe the accident prevention regulations and any regional regulations!
- Inform persons in the working area that they must comply with the regulations!

These supplementary sheets must be used in conjunction with the appropriate standard operating instructions for the described product! These supplementary sheets expand or replace one or more chapters of the same name(s) in the standard description.

Read and observe the operating instructions for all system components, especially the safety instructions!

2 Intended use

2.1 General

WARNING



Hazards due to improper usage!

The machine has been constructed to the state of the art and any regulations and standards applicable for use in industry and trade. It may only be used for the welding procedures indicated at the rating plate. Hazards may arise for persons, animals and material objects if the equipment is not used correctly. No liability is accepted for any damages arising from improper usage!

- The equipment must only be used in line with its designated purpose and by trained or expert personnel!
- Do not improperly modify or convert the equipment!

2.2 Applications

The option described below enables operating a welding torch with 8-pole connection socket.

2.3 Use and operation solely with the following machines

- Tetrax 180 Comfort 5P TGD (from serial No. 196718 onwards)
- Tetrax 200 MV Puls 5P TG
- Tetrax 200 puls 5p TG
- Tetrax 230 DC
- Tetrax 230 AC/DC
- Tetrax 270 DC
- Tetrax 300 AC/DC Comfort 2.0
- Tetrax 300 AC/DC Smart 2.0
- Tetrax 300-2
- Triton 230 DC
- Triton 230 AC/DC

2.4 Short description of the working steps required

- Remove the 5-pole connection socket (torch control lead).
- Install the 8-pole connection socket to operate a torch with a display or special functions.

3 Conversion

3.1 Parts list

Before conversion, check that the retrofit kit is complete (see parts list).

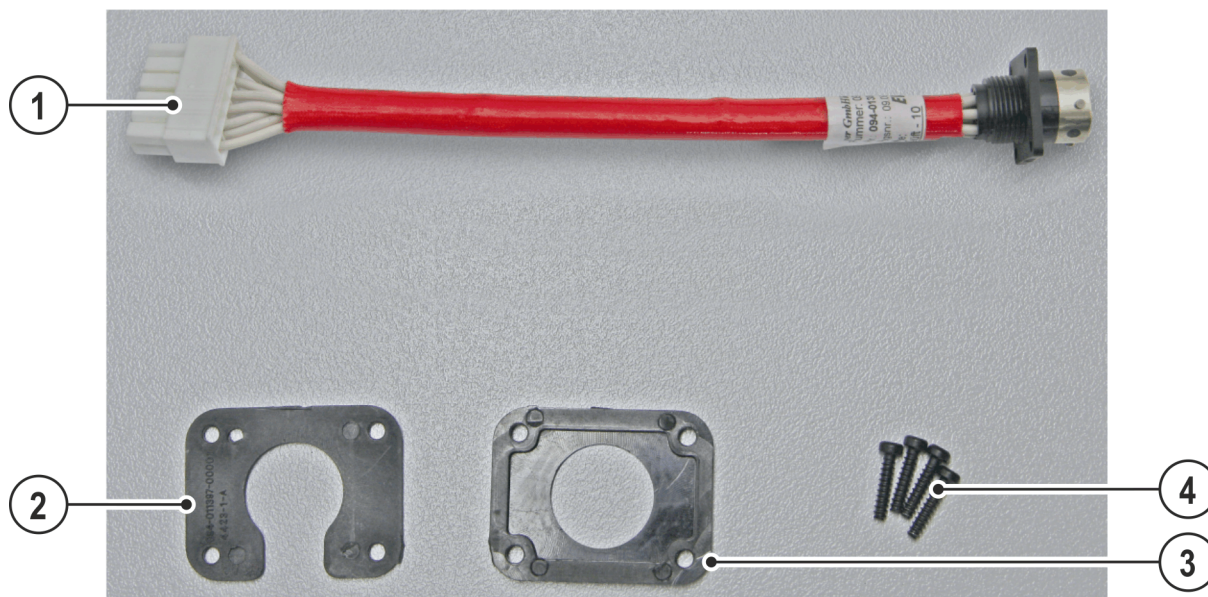

Figure 3-1

Item	Quantity	Description	Item number
1	1	Connection socket with cable harness	094-013014-00002
2	1	Reducing adaptor 8/12 pole	094-012147-00000
3	1	Adapter plate	094-012145-00000
4	4	TORX screw M3 x 14 Delta-PT	094-011612-00000

3.2 Assembly

- Unscrew the casing cover.

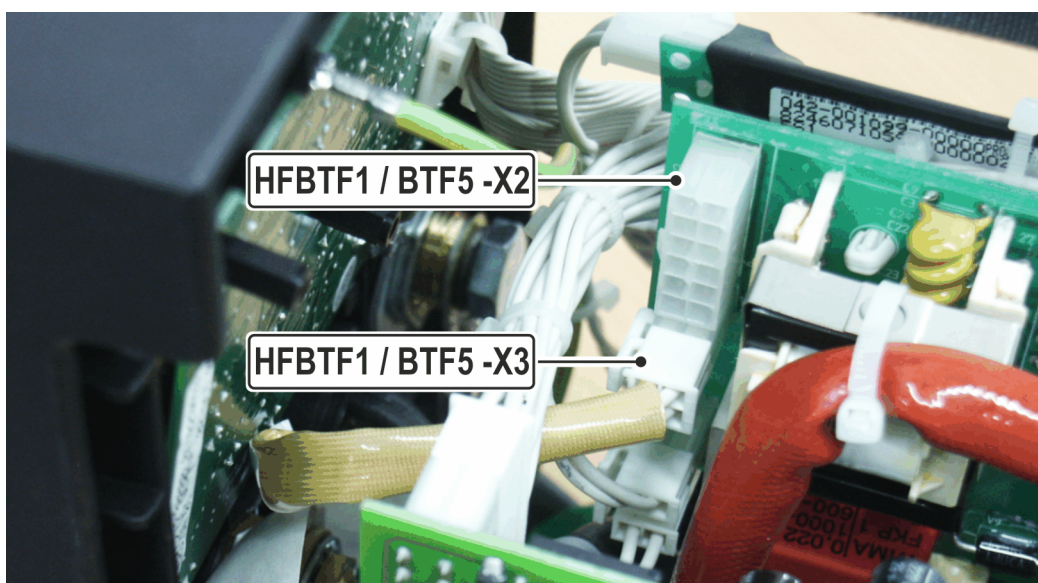

Figure 3-2

- Disconnect the torch control lead from the HFBTF1, X3 PCB.

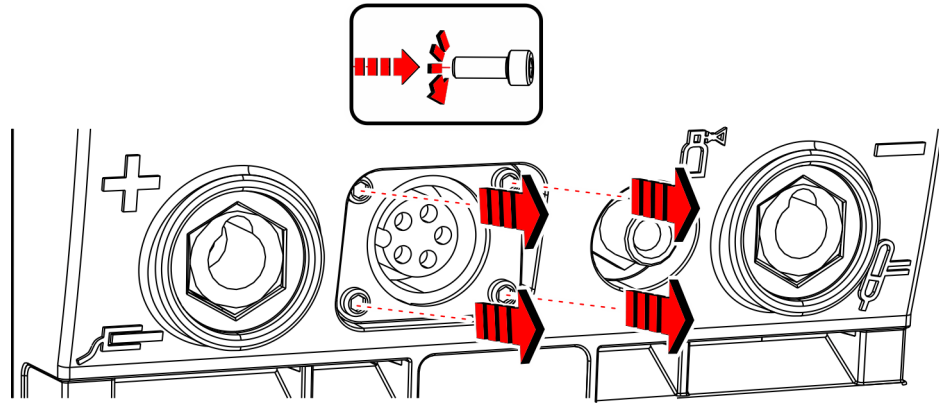

Figure 3-3

- Disconnect and remove the 5-pole torch connection socket from the machine front.

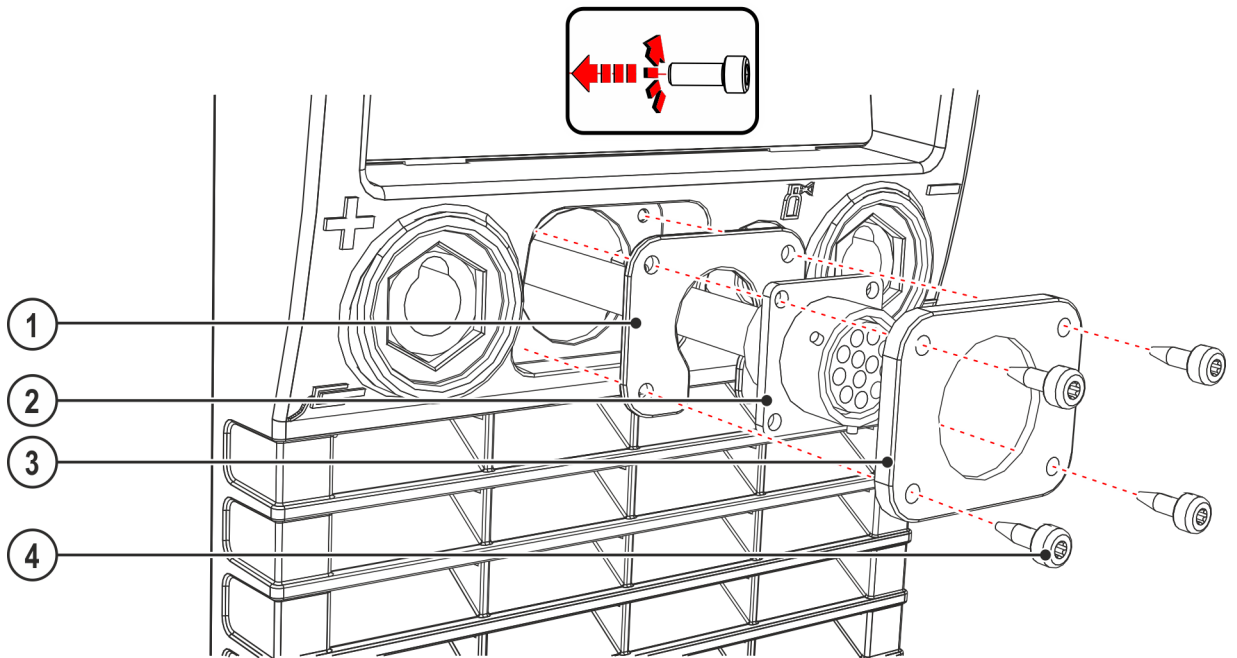

Figure 3-4

Item	Quantity	Description	Item number
1	1	Reducing adaptor 8/12 pole	094-012147-00000
2	1	Connection socket with cable harness	094-013014-00002
3	1	Adapter plate	094-012145-00000
4	4	TORX screw M3 x 14 Delta-PT	094-011612-00000

- Screw the 8-pole torch connection socket to the machine front using mounting material.

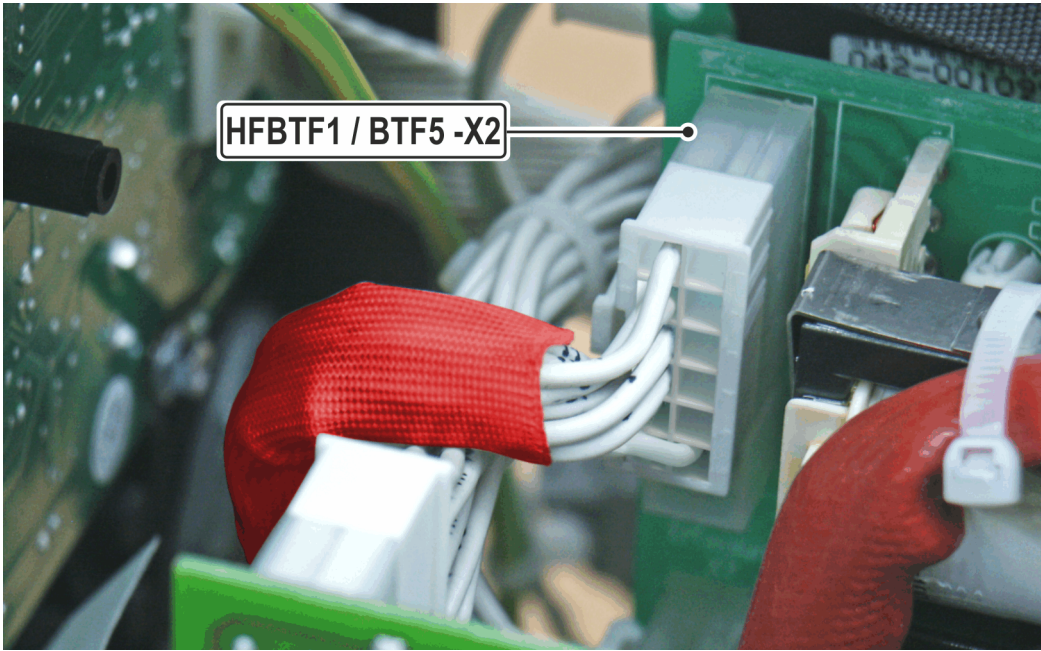

Figure 3-5

- Plug the torch control lead connector plug into the HFBTF1, X2 PCB.
- Assemble the machine in the reverse order.

3.2.1 Wiring plan

HFBTF1 / BTF5

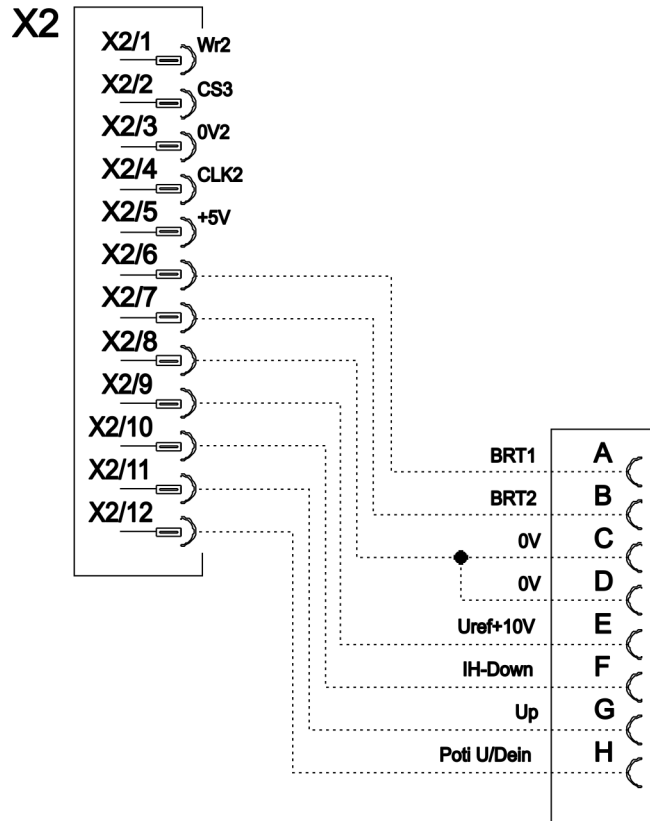

Figure 3-6

3.3 Final inspection

3.3.1 General

WARNING



Protective earth PE!

To protect persons and animals against dangerous live voltages and electric shocks in the event of a fault, the casing panels on the unit are connected to a green/yellow protective earth.

- After conversion, re-connect the protective earth to the casing panels!



Danger due to failure to carry out the final inspection!

After installation or conversion, all mechanical and electrical connections must be checked for correct installation to avoid any potential injuries.

- No leads or tubes should be squashed or laid on sharp edges.
- Check all mechanical connections to ensure that they are fitted correctly!
- Carry out the final inspection!
- Carry out the functional test!



Dangers resulting from failure to perform test after conversion!

Before reconnection, “Inspection and Testing during Operation” according to IEC/BS EN 60974-4 “Arc welding systems – Inspection and Testing during Operation” has to be performed!

- Perform test to IEC / DIN EN 60974-4!

Keep the conversion instructions with the machine documentation!

When ordering spare parts, ensure that the item number and serial number of the machine are quoted!