



EN

Retrofit option

ON PS drive IC 4 Wheels F.0001

Set comprising pivot support and wheel kit for Drive 4 type wire feeders

099-002284-EW501

Observe additional system documents!

11.07.2019

**Register now
and benefit!
Jetzt Registrieren
und Profitieren!**

www.ewm-group.com



General instructions

WARNING



Read the operating instructions!

The operating instructions provide an introduction to the safe use of the products.

- Read and observe the operating instructions for all system components, especially the safety instructions and warning notices!
- Observe the accident prevention regulations and any regional regulations!
- The operating instructions must be kept at the location where the machine is operated.
- Safety and warning labels on the machine indicate any possible risks. Keep these labels clean and legible at all times.
- The machine has been constructed to state-of-the-art standards in line with any applicable regulations and industrial standards. Only trained personnel may operate, service and repair the machine.
- Technical changes due to further development in machine technology may lead to a differing welding behaviour.

In the event of queries on installation, commissioning, operation or special conditions at the installation site, or on usage, please contact your sales partner or our customer service department on +49 2680 181-0.

A list of authorised sales partners can be found at www.ewm-group.com/en/specialist-dealers.

Liability relating to the operation of this equipment is restricted solely to the function of the equipment. No other form of liability, regardless of type, shall be accepted. This exclusion of liability shall be deemed accepted by the user on commissioning the equipment.

The manufacturer is unable to monitor whether or not these instructions or the conditions and methods are observed during installation, operation, usage and maintenance of the equipment.

An incorrectly performed installation can result in material damage and injure persons as a result. For this reason, we do not accept any responsibility or liability for losses, damages or costs arising from incorrect installation, improper operation or incorrect usage and maintenance or any actions connected to this in any way.

© **EWM AG**

Dr. Günter-Henle-Strasse 8
56271 Mündersbach Germany
Tel.: +49 2680 181-0, Fax: -244
Email: info@ewm-group.com
www.ewm-group.com

The copyright to this document remains the property of the manufacturer.

Copying, including extracts, only permitted with written approval.

The content of this document has been prepared and reviewed with all reasonable care. The information provided is subject to change; errors excepted.

1 For your safety**1.1 Safety instructions****⚠ WARNING**

Do not carry out any unauthorised repairs or modifications!

To avoid injury and equipment damage, the unit must only be repaired or modified by specialist, skilled persons!

The warranty becomes null and void in the event of unauthorised interference.

- Appoint only skilled persons for repair work (trained service personnel)!



Risk of accidents due to non-compliance with the safety instructions!

Non-compliance with the safety instructions can be fatal!

- Carefully read the safety instructions in this manual!
- Observe the accident prevention regulations and any regional regulations!
- Inform persons in the working area that they must comply with the regulations!

These supplementary sheets must be used in conjunction with the appropriate standard operating instructions for the described product! These supplementary sheets expand or replace one or more chapters of the same name(s) in the standard description.

Read and observe the operating instructions for all system components, especially the safety instructions!

1.2 Transport and installation**⚠ WARNING**

Improper work carried out!

In the event of improper work carried out on the display stand, the display stand may lose stability, tip over and result in serious injury!

- Only use the construction and fitting parts supplied!
- Do not load the display stand without reinforcement panels affixed!

⚠ CAUTION

Improperly secured equipment!

Equipment, equipment combinations and accessories incorrectly fastened onto transport systems can tip over during transport and cause injuries!

- Only used the original parts supplied to fasten the equipment.
- Use the systems only for transporting the machines .
- Check the fixing points before each transport and at regular intervals.



Risk of accidents due to supply lines!

During transport, attached supply lines (mains leads, control cables, etc.) can cause risks, e.g. by causing connected machines to tip over and injure persons!

- Disconnect all supply lines before transport!

2 Intended use

2.1 General

WARNING



Hazards due to improper usage!

The machine has been constructed to the state of the art and any regulations and standards applicable for use in industry and trade. It may only be used for the welding procedures indicated at the rating plate. Hazards may arise for persons, animals and material objects if the equipment is not used correctly. No liability is accepted for any damages arising from improper usage!

- The equipment must only be used in line with its designated purpose and by trained or expert personnel!
- Do not improperly modify or convert the equipment!

2.2 Applications

Use the option described below to add a device to the welding system to rotate the wire feeder and to add the wire feeder with a set of wheels.

These instructions apply only for the conversion of the following machines:

- drive 4 IC
- drive 4X IC
- alpha Q 351, 551 Progress puls MM FDW
- Phoenix 351, 401, 451, 551 Progress puls MM FDW
- Taurus 351, 401, 451, 551 Basic FDG, -FDW
- Taurus 351, 401, 451, 551 Synergic S MM FDG, -FDW

2.3 Short description of the working steps required

- Install the option
- Install the wire feeder
- Perform final inspection

3 Conversion

3.1 General

⚠ DANGER

 **Risk of injury from electric shock!**
Servicing machines that are not disconnected from the mains can lead to serious injuries!

- Disconnect the machine completely from the mains.
Pull out the mains plug!
- Wait for 4 minutes until the capacitors have discharged!

3.2 Parts list

Before conversion, check that the retrofit kit is complete (see parts list).

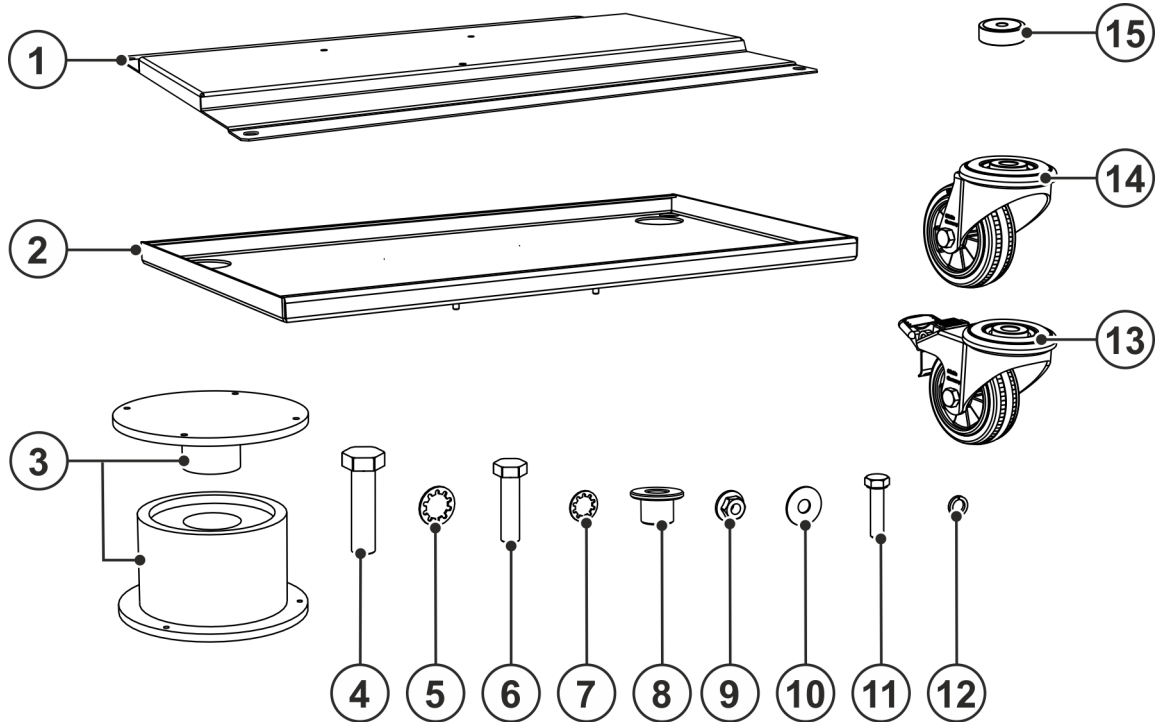

Figure 3-1

Item	Quantity	Description	Item number
1	1	Pivot support panel	094-011423-00000
2	1	Wire feeder support panel	094-001147-00004
3	1	Pivot support assembly	094-001066-00000
4	4	Hexagon screw M12 x 45	094-002147-00000
5	4	toothed lock washer M12	094-002065-00000
6	4	Hexagonal screw M8 x 45	064-000660-00000
7	4	Flap disc M8	064-000592-00000
8	4	Adapter wheel	094-024706-00000
9	4	Serrated washer nut M5	094-001139-00000
10	7	cup spring M5	064-000751-00000
11	3	hexagonal screw M5 x 20	064-000635-00000
12	3	spring lock washer M5	064-000594-00000
13	2	Guide castor, with lock	094-000180-00002
14	2	Guide castor	094-000180-00001
15	4	Position washer	094-011544-00000

3.3 Assembly

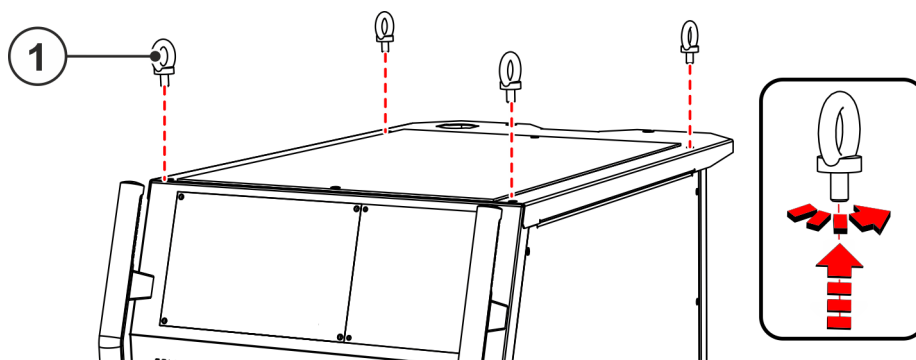

Figure 3-2

Item	Quantity	Description	Item number
1	1	Lifting eye	

- Unscrew the lifting eyes and flap discs.

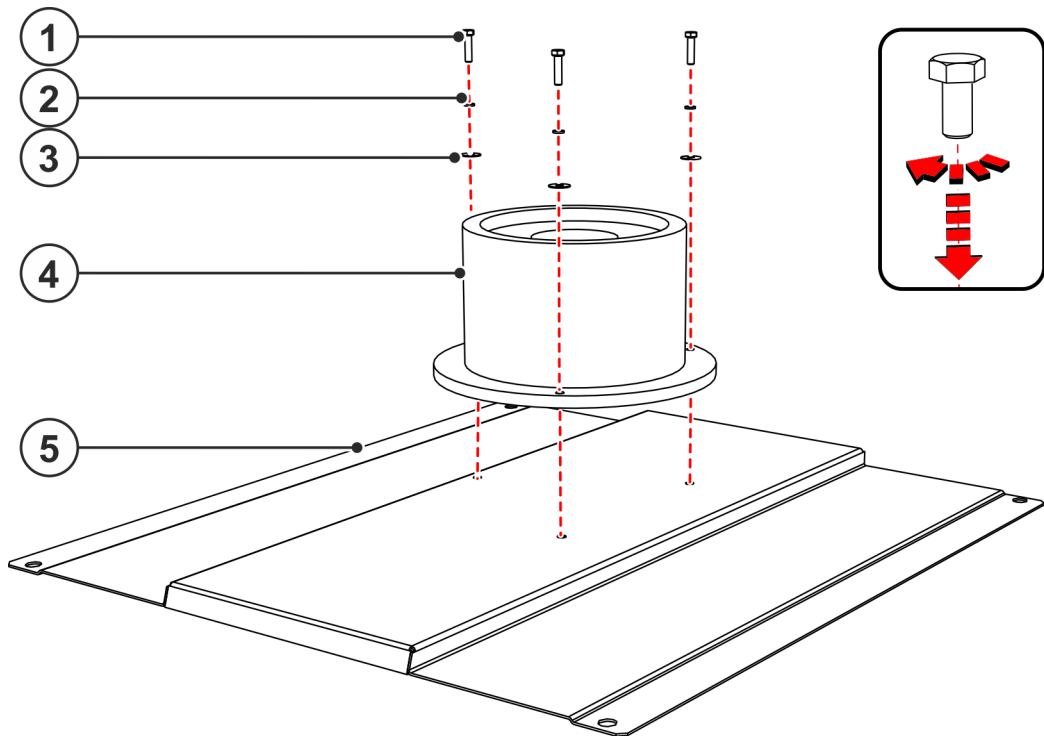

Figure 3-3

Item	Quantity	Description	Item number
1	3	hexagonal screw M5 x 20	064-000635-00000
2	3	Cup spring M5	064-000751-00000
3	3	spring lock washer M5	064-000594-00000
4	1	Pivot support assembly	094-001066-00000
5	1	Pivot support panel	094-011423-00000

- Screw the lower section of the pivot support to the pivot support panel using 3 M5 x 20 hexagonal screws, M5 cup springs and M5 spring lock washers.

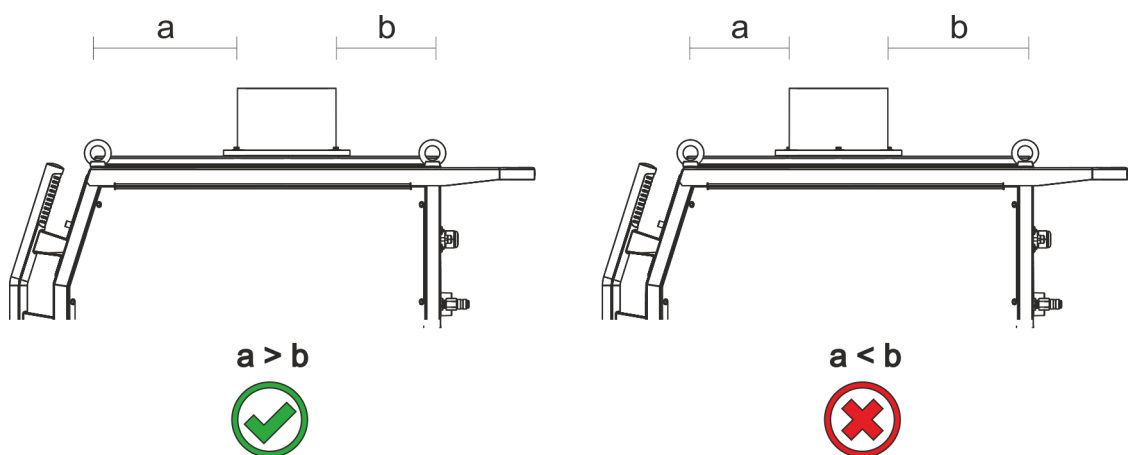

Figure 3-4

The bores in the pivot support panel are not centred. Attach the panel in such a way to the welding machine that the greater distance between the lower section of the pivot support and the panel edge points to the front of the welding machine.

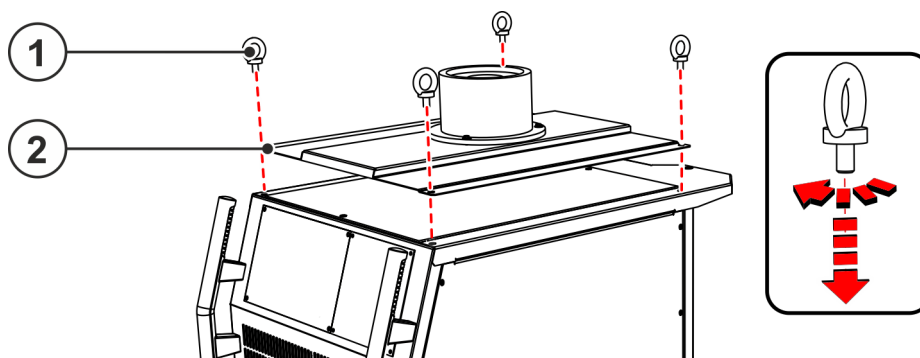

Figure 3-5

Item	Quantity	Description	Item number
1	1	Lifting eye	
2	1	Pivot support panel	094-011423-00000

- Screw the pivot support panel to the welding machine using lifting eyes and flap discs.

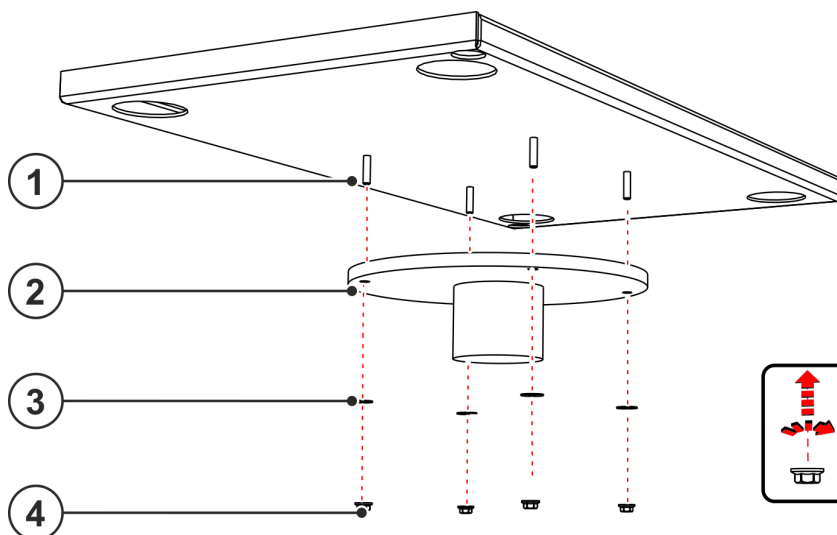

Figure 3-6

Item	Quantity	Description	Item number
1	1	Wire feeder support panel	094-001147-00004
2	1	Pivot support assembly	094-001066-00000
3	4	Disk spring M5	064-000751-00000
4	4	Serrated washer nut M5	094-001139-00000

- Screw the upper section of the pivot support to the wire feeder support panel using 4 M5 nuts and M5 cup springs.

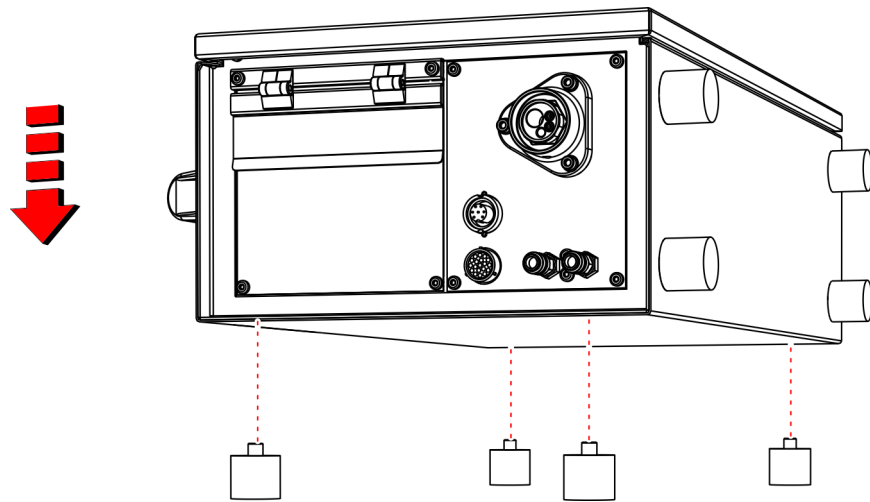

Figure 3-7

- Unscrew the machine feet from the wire feeder.

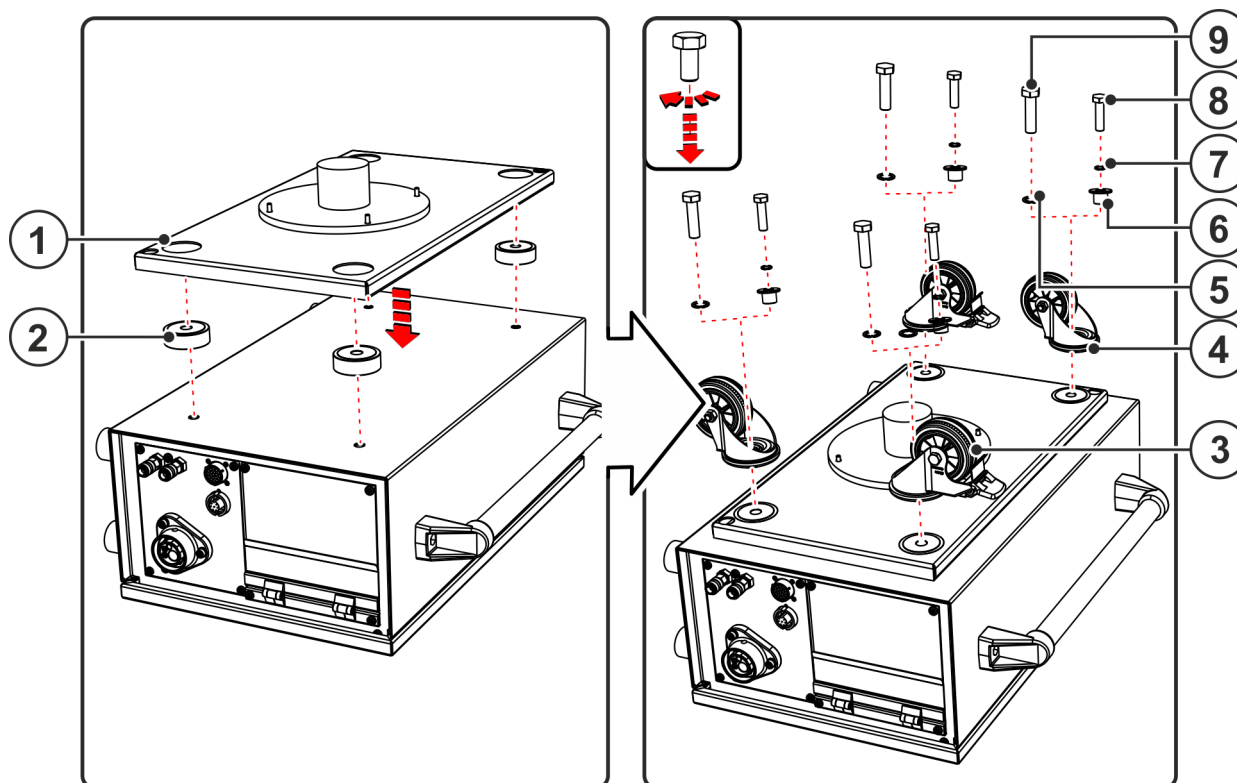

Figure 3-8

Item	Quantity	Description	Item number
1	1	Wire feeder support panel	094-001147-00004
2	4	Position washer	094-011544-00000
3	2	Guide castor, with lock	094-000180-00002
4	2	Guide castor	094-000180-00001
5	4	toothed lock washer M12	094-002065-00000
6	4	Adapter wheel	094-024706-00000
7	4	Flap disc M8	064-000592-00000
8	4	Hexagonal screw M8 x 45	064-000660-00000
9	4	Hexagon screw M12 x 45	094-002147-00000

Select the thread diameter of the fastening material according to the thread of the wire feeder.

- Place spacer discs with the flat side on the wire feeder.
- Place the wire feeder support panel on the chamfered side of the spacer disc.
- Screw the guide castors diagonally offset onto the holder for the wire feeder using the fastening material .

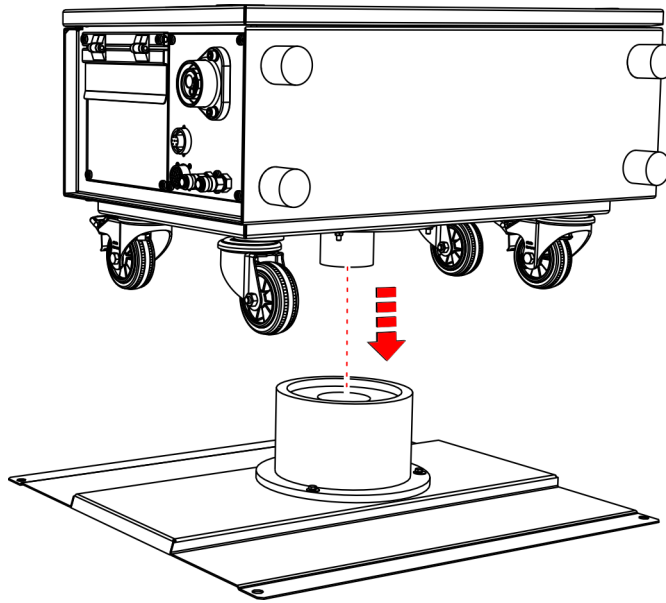

Figure 3-9

- With the help of a second person, place the wire feeder onto the wire feeder support panel.

3.4 Final inspection

⚠ WARNING



Danger due to failure to carry out the final inspection!

Parts that are incorrectly fitted or that become loose are a source of danger.

- Check all mechanical connections to ensure that they are fitted correctly!
- Carry out the final inspection!
- Carry out the functional test!

Keep the conversion instructions with the machine documentation!

When ordering spare parts, ensure that the item number and serial number of the machine are quoted!