



Retrofit option

ON LB Wheels 160x40MM

Locking brake for machine wheels

General instructions

CAUTION



Read the operating instructions!

The operating instructions provide an introduction to the safe use of the products.

- Read the operating instructions for all system components!
- Observe accident prevention regulations!
- Observe all local regulations!
- Confirm with a signature where appropriate.

NOTE



In the event of queries on installation, commissioning, operation or special conditions at the installation site, or on usage, please contact your sales partner or our customer service department on +49 2680 181-0.

A list of authorised sales partners can be found at www.ewm-group.com.

Liability relating to the operation of this equipment is restricted solely to the function of the equipment. No other form of liability, regardless of type, shall be accepted. This exclusion of liability shall be deemed accepted by the user on commissioning the equipment.

The manufacturer is unable to monitor whether or not these instructions or the conditions and methods are observed during installation, operation, usage and maintenance of the equipment.

An incorrectly performed installation can result in material damage and injure persons as a result. For this reason, we do not accept any responsibility or liability for losses, damages or costs arising from incorrect installation, improper operation or incorrect usage and maintenance or any actions connected to this in any way.

1 Contents

1 Contents	3
2 Safety instructions	4
3 Overview	5
3.1 Proper usage	5
3.2 Short description of the working steps required	5
4 Conversion	6
4.1 Mounting on the trolley.....	6
4.2 Mounting on the machine	7
4.2.1 Screws inside the casing.....	9
4.3 Functional characteristics	10
4.4 Final inspection	11
5 Technical data	11

2 Safety instructions



DANGER



Do not carry out any unauthorised repairs or modifications!

To avoid injury and equipment damage, the unit must only be repaired or modified by specialist, skilled persons!

The warranty becomes null and void in the event of unauthorised interference.

- Appoint only skilled persons for repair work (trained service personnel)!



WARNING



Validity of this document!

This document is only valid in combination with the operating instructions for the power source being used (welding machine)!

- Read the operating instructions, in particular the safety instructions for the power source (welding machine)!



Risk of accidents if these safety instructions are not observed!

Non-observance of these safety instructions is potentially fatal!

- Carefully read the safety information in this manual!
- Observe the accident prevention regulations in your country.
- Inform persons in the working area that they must observe the regulations!

CAUTION



Obligations of the operator!

The respective national directives and laws must be observed for operation of the machine!

- National implementation of the framework directive (89/391/EEG), as well as the associated individual directives.
- In particular, directive (89/655/EEG), on the minimum regulations for safety and health protection when staff members use equipment during work.
- The regulations regarding work safety and accident prevention for the respective country.
- Setting up and operating the machine according to IEC 60974-9.
- Check at regular intervals that users are working in a safety-conscious way.
- Regular checks of the machine according to IEC 60974-4.

3 Overview

3.1 Proper usage

WARNING



Hazards due to improper usage!

Hazards may arise for persons, animals and material objects if the equipment is not used correctly. No liability is accepted for any damages arising from improper usage!

- The equipment must only be used in line with proper usage and by trained or expert staff!
- Do not modify or convert the equipment improperly!

NOTE



Simultaneous use with the listed options is not intended and is therefore not permissible!

- ON Shock Protect (092-002154-00000)

These instructions apply only for the conversion of the following machines:

- alpha Q 351 / 551
- Phoenix 351 / 401 / 451 / 551
- Taurus 351 / 401 / 451 / 551
- Wega 401 / 501 / 601
- Tetrix 351 / 451 / 551
- Tetrix AC/DC 351 / 451 / 551
- Trolly 55.2
- Trolly 55.2-2
- Trolly 75-2
- Trolly 70-3
- Trolly 70-3 DF

3.2 Short description of the working steps required

- Detach guide castor **without** parking brake.
- Mount guide castor **with** parking brake.

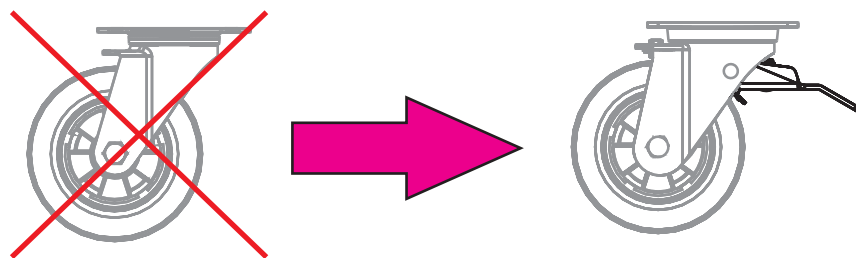

Figure 3-1

4 Conversion
4.1 Mounting on the trolley

NOTE

The illustration serves as an example only.

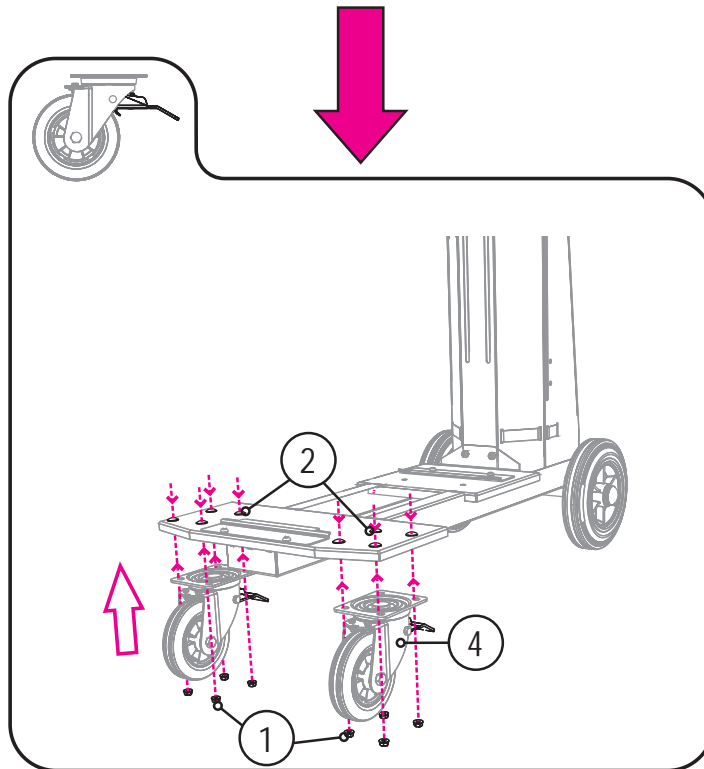
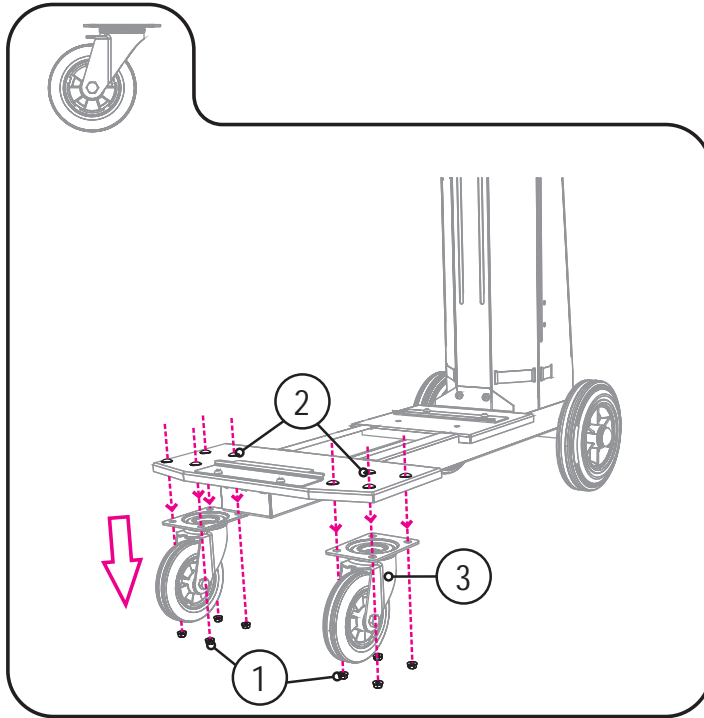
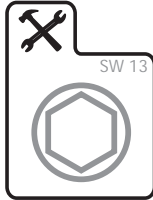

Figure 4-1

4.2 Mounting on the machine

NOTE

 The illustration serves as an example only.

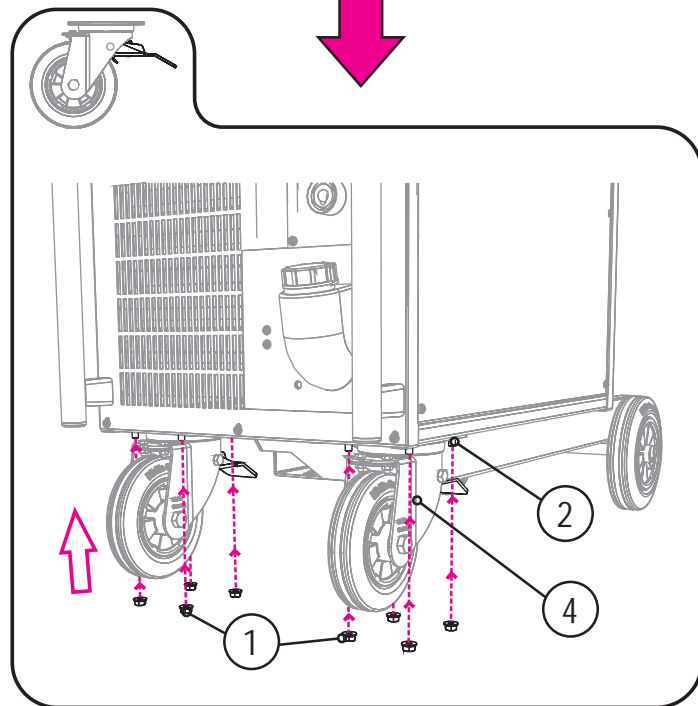
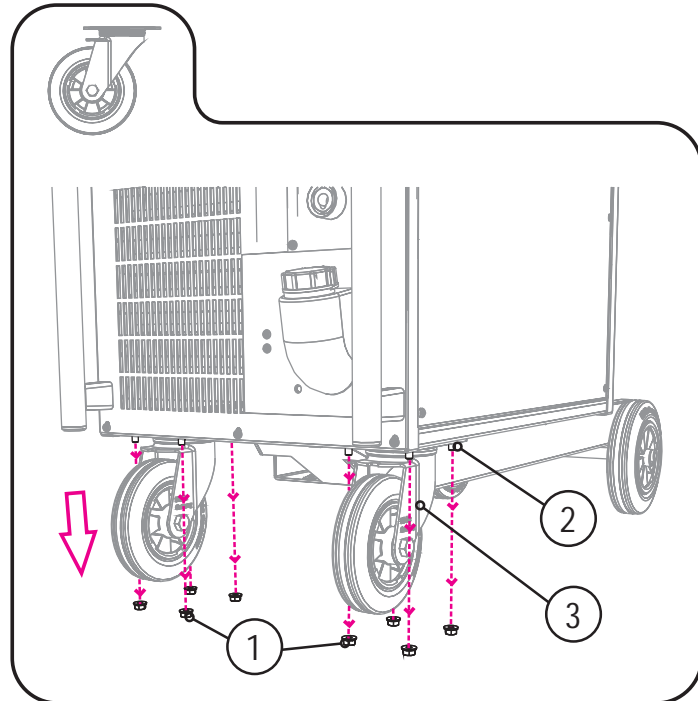
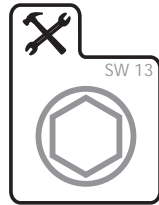

Figure 4-2

NOTE

 Screw inside the casing – see the next chapter.

Conversion

Mounting on the machine



Item	Symbol	Description
1		Hexagon nut
2		Flat head screw
3		Guide castor without parking brake
4		Guide castor with parking brake

- Set up the object to work on so that both wheels can be detached.
- Unscrew 4 hexagonal nuts per wheel.
- Mount wheel with parking brake.

4.2.1 Screws inside the casing

⚠ DANGER**Risk of injury from electric shock!**

Servicing machines that are not disconnected from the mains can lead to serious injuries!

- Disconnect the machine completely from the mains.
- Unplug the mains plug!
- Wait for 4 minutes until the capacitors have discharged!

**Protective earth PE!**

To protect persons and animals against dangerous live voltages and electric shocks in the event of a fault, the casing panels on the unit are connected to a green/yellow protective earth.

- After conversion, re-connect the protective earth to the casing panels!

NOTE

The illustration serves as an example only.

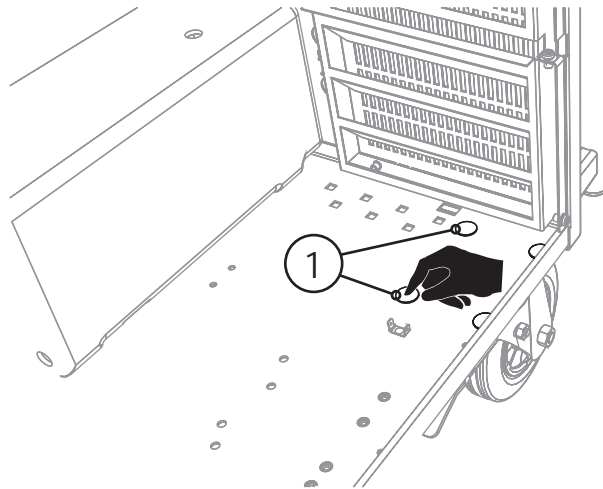

Figure 4-3

Item	Symbol	Description
1		Flat head screw

- Unscrew the left casing panel.
- Remove the earthing cable from the casing panel.
- Tighten the nuts, holding the oval-head screws in position if necessary.

4.3 Functional characteristics

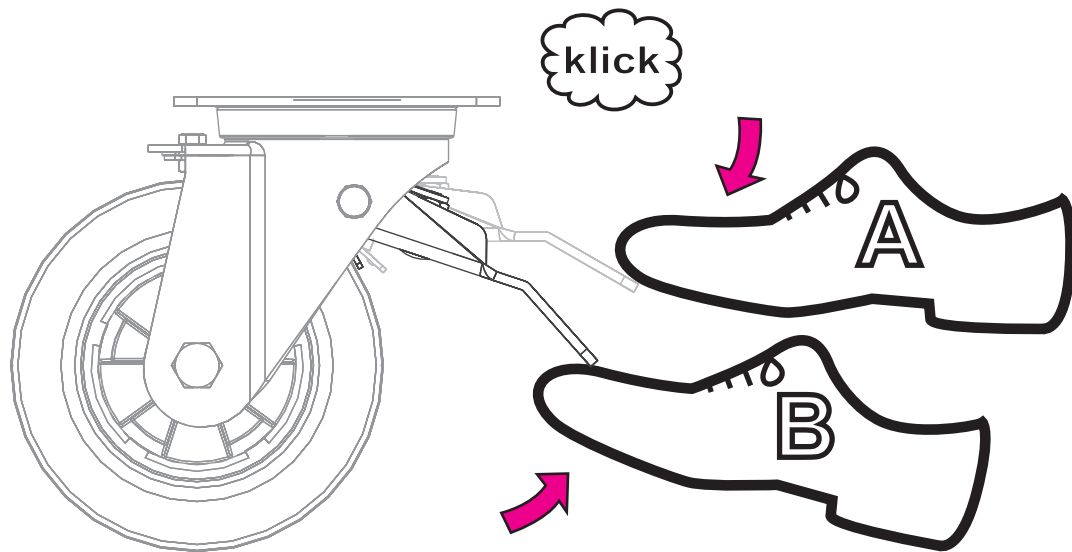

Figure 4-4

- Activate the parking brake until the mechanism locks in place (A).
- Check for stable position.
- Unlock the parking brake by pulling the latch up (B).

4.4 Final inspection

DANGER



Protective earth PE!

To protect persons and animals against dangerous live voltages and electric shocks in the event of a fault, the casing panels on the unit are connected to a green/yellow protective earth.

- After conversion, re-connect the protective earth to the casing panels!

WARNING



Danger due to failure to carry out the final inspection!

After installation or conversion, all mechanical and electrical connections must be checked for correct installation to avoid any potential injuries.

- No leads or tubes should be squashed or laid on sharp edges.
- Check all mechanical connections to ensure that they are fitted correctly!
- Carry out the final inspection!
- Carry out the functional test!

CAUTION



Test!

Before re-commissioning, it is essential that an "inspection and test during operation" is carried out conforming to IEC / DIN EN 60974-4 "Arc welding devices - inspection and testing during operation"!

- For detailed instructions, please see the standard operating instructions for the welding machine.

NOTE



- Keep the conversion instructions with the machine documentation!
- When ordering spare parts, ensure that the item number and serial number of the machine are quoted!

5 Technical data

NOTE



The technical data given here completes or replaces the respective values in the standard operating instructions.

- Weight: +0,9 kg